

INTRODUCTION

Hostar International, Inc. provides hoteliers with the smart solution to material management within their operations. As a management tool, the ProHost® System works to improve productivity while increasing employee morale. It allows managers to reach quality standards while improving their operating efficiency.



Improved productivity generated by the ProHost® System yields long-term savings. Productivity improvements generate quality, efficiency, and employee satisfaction. The ProHost® System controls and manages inventories through centralized inventory control and just-in-time delivery to the guest floors.

Hostar's clients range from 150-room luxury boutique hotels to 3,000 room mega properties. The company has a broad client base that includes properties from the world's leading hotel companies. Hostar is recognized as an industry leader delivering quality products and services to its customers worldwide.

The ProHost® System is the only housekeeping materials management program that generates significant savings for each occupied room night.

Hostar delivers intelligent equipment combined with full service design and implementation of material-handling systems.



The ProHost® System combines process and equipment to ensure accurate and efficient delivery of finished linens and supplies to the guest floors. An integrated family of Mobiles and totes carry program-loaded quantities to each floor, replacing traditional room attendant carts, linen closet shelving and house attendant collection carts.

The ProHost® System delivers consistent quantities to each guestroom floor on a daily basis. The result is improved quality within the guestroom and more time for the room attendant to focus on service to hotel guests.

Inventory control is improved with the centralization of all linen and supplies. The ProHost® System eliminates hundreds of material handling events per day. System users report that room attendants complete daily assignments 30 to 45 minutes faster using the System.

For more information on how the ProHost® System can positively impact your hotel or resort operation, contact Hostar International, Inc.

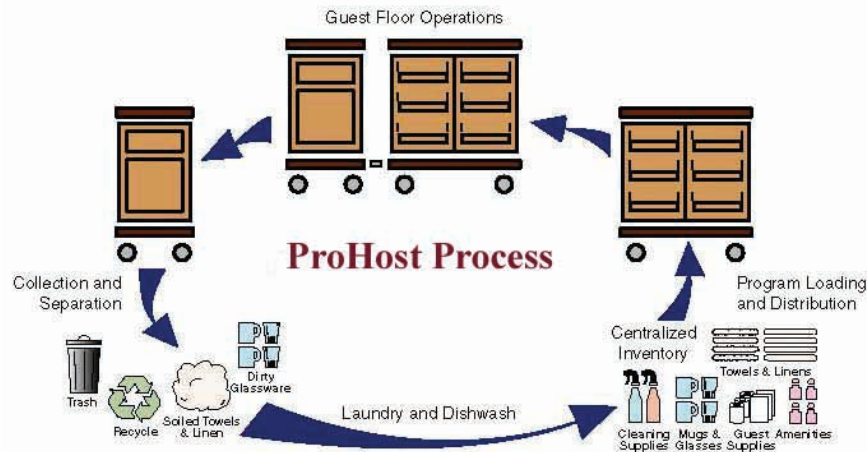

FEASIBILITY STUDY

Hostar develops an operational plan and a preliminary equipment specification based upon the physical space and layout of the property, staff assignments, and management goals of the hotel. Daily workshops are held with hotel management to customize the ProHost® System.

DETAILED PLANNING

Hostar spends five days on-site working with hotel management to complete a detailed operations plan, finalize equipment configurations, and review the installation agenda and schedule. The equipment plan is based on the room mix, housekeeping sections, room attendant assignments, house attendant assignments, and evening shift activities. Procedures for room cleaning using the ProHost® System are presented to housekeeping managers and floor supervisors.

PREPARATION OF OPERATIONS MANUAL

A detailed training and procedures manual is prepared by Hostar. The manual includes operational procedures, photographs and drawings of Mobile configurations, tote loads and linen closet parking plans.

SYSTEM IMPLEMENTATION

The Hostar installation team spends ten to twelve days on site to assist the hotel receive the ProHost® equipment, organize initial linen and room supply stocking, and deliver the Mobiles to the guest floor linen closets. Hostar assists housekeeping management in conducting training for all housekeeping personnel in the most effective use of the ProHost® equipment.

FOLLOW-UP VISIT AND SYSTEM RECOMMENDATIONS

Hostar conducts a follow-up visit, within six months of the installation, to review the operation of the ProHost® System to ensure that management goals are met.

OPTIONAL IN-ROOM CLEANING TRAINING

Experienced Hostar trainers conduct housekeeping training both in classroom and guestroom settings, to provide hands-on demonstrations and practice. Topics include customer service and professionalism, guest floor security issues, safe body mechanics and the fundamentals of guestroom cleaning.

The ProHost® Luxury/Boutique Program maintains a "cartless appearance" in the guestroom corridors while providing room attendants with a tool to significantly improve productivity and guest room quality.

Room attendants are provided with pre-loaded Handy Suppliers, sized to go inside the guestroom, containing exact quantities of amenities, room supplies and cleaning products for a daily assignment. Suppliers or Tote Carriers are specified to carry daily quantities of linen and towels to the linen closets.

Hotel owners and managers operate in an environment that demands increased efficiency and productivity. They must also meet their customers' needs for high levels of quality accommodation and service. The ProHost® System provides management with the technology to meet these goals in the heart-of-the-house.

HANDY SUPPLIER



ORGANIZATION

The ProHost® Handy Supplier organizes tools, linen, and supplies while maintaining a minimal profile in guest areas. Slim enough to go into guestrooms during the room cleaning process, it allows housekeeping programs to be truly invisible.

TOTE CARRIER FOR RESERVE LINEN

The ProHost® Luxury/Boutique Program delivers first-class appearance, consistent quality and improved productivity for five-star housekeeping operations. For more information on how the ProHost® System can positively impact your hotel or resort, contact Hostar International, Inc.

EFFICIENCY

Loaded with totes of linen, terry, amenities, and supplies, Tote Carriers are distributed to guest floor service closets. Color-coded totes allow quick, accurate identification of items.

The ProHost® Campus/Villas Program teams up transport vehicles with ProHost® System efficiency to deliver consistent quality and improved productivity for housekeeping or food and beverage operations. Housekeeping (room attendant activity, turndown service and soiled linen/trash collection) and food and beverage (minibar and room service tray collection) can benefit from the systematic delivery and collection of supplies utilizing ProHost® totes and Mobiles. Designed to maneuver on narrow paths and walkways, the transport vehicles maintain a professional, five-star appearance while maximizing productivity. For more information on how the ProHost® System can positively impact your hotel or resort, contact Hostar International, Inc.

ProHost® Campus/Villas programs are custom designed to meet each property's unique challenges. Guest rooms may be serviced directly from the ProHost® Transport vehicle (see top and center photos) or from Mobiles delivered to service closets in individual buildings (see bottom photo). Both Systems allow for accurate and efficient delivery of supplies when supported by program-loaded Mobiles and totes.



HOUSEKEEPING/TURNDOWN SETUP



REFRESHMENT CENTER/MINIBAR RESTOCKING SETUP



MOBILE DELIVERY - ROLL-ON/ROLL-OFF

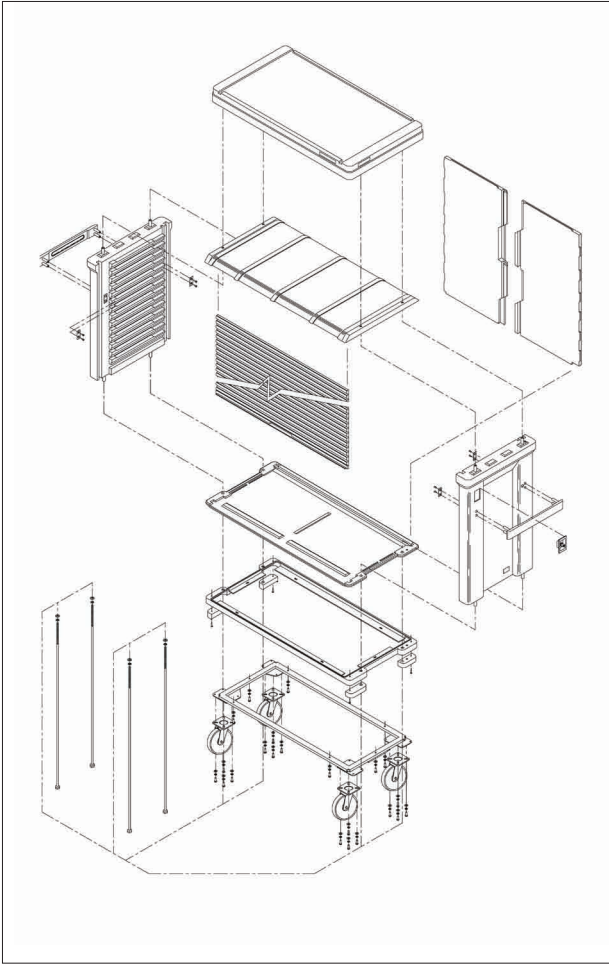

Hostar offers replacement parts and on-site service to refurbish Mobiles for properties with ProHost equipment.

ProHost® Mobile components are designed to be “field-replaceable”, meaning individual parts may be ordered from Hostar International, Inc. and repaired using ordinary tools found in most engineering departments.

A full equipment audit is recommended every four to five years and can be conducted by hotel personnel or by Hostar field service professionals at no charge.

Refurbishment quotes and service plans are developed for departmental budgeting. For more information, please request a quote by contacting Hostar International, Inc. - Field Service at (440) 564-7400.

DESCRIPTION

Appearance, maneuverability and capacity make the Mobile Supplier the preferred choice for guest room cleaning in housekeeping operations. Supply totes are custom configured to accommodate guest room amenities, room supplies, linen and terry. Standard features include tambour door with security lock and hitch to connect to the Mobile Collector. Optional features include power assist.

PRODUCT NUMBER

SMV-STND-J8H08 (shown right)
SMV-PWRV-J8H08 (with power assist)

MOBILE SUPPLIER



"In the process of servicing a normal fourteen to sixteen rooms per day, an attendant will execute over seven thousand individual manipulations of materials and equipment. Room attendant activity is labor-intensive."

*The New Back-of-the-House, Running the Smart Hotel
Robert Propst*

Exterior Dimensions						Interior Dimensions					
Length		Width		Height		Length		Width		Height	
(in.)	(mm)	(in.)	(mm)	(in.)	(mm)	(in.)	(mm)	(in.)	(mm)	(in.)	(mm)
49	1245	23	585	51	1295	42	1065	17.5	445	37.5	955
Weight (lbs.) (kg)				Mobile heights listed above are with standard 6" casters. Mobile widths and lengths include Revolving Bumpers.						Volume (ft ³) (m ³)	
156 71										15 .43	

MOBILE COLLECTOR



DESCRIPTION

Neat appearance and clear separation of soiled linen and trash from clean linen and supplies make the Mobile Collector unique in the industry. The Collector is small enough to be placed in the guest room as housekeeping occurs, keeping guest corridors looking tidy throughout the day. Standard features include Trash Tote and Soiled Linen Bin, vacuum shelf and hitch to connect to Mobile Suppliers.

PRODUCT NUMBER

150C-HK-0001 (shown upper left)
CCA-J8BNVREH-T1 (shown lower left,
with rising platform and external bin)

OPTIONAL FEATURES

External Bin
Rising Linen Platform

Exterior Dimensions						Interior Dimensions					
Length		Width		Height		Length		Width		Height	
(in.)	(mm)	(in.)	(mm)	(in.)	(mm)	(in.)	(mm)	(in.)	(mm)	(in.)	(mm)
31	785	21.5	545	51	1295	21.5	545	17.5	445	36.5	925
Weight (lbs.) (kg)				Mobile heights listed above are with standard 6" casters.						Volume (ft ³) (m ³)	
133 60.5										8 .23	

HOUSEKEEPING MOBILES

MOBILE HANDY SUPPLIER



DESCRIPTION

The Mobile Handy Supplier provides Luxury Suite/ Boutique hotels with an “invisible” housekeeping alternative. Handy Suppliers are half the width of other Mobiles, and can easily be placed in the guest room during the cleaning process. Handy Suppliers carry essential cleaning tools and guest supplies. Popular with both room attendants and housekeeping managers, the Mobile Handy Supplier overcomes challenges presented by “no cart” programs.

PRODUCT NUMBER

CH-J6BNVRNH (shown left)

Exterior Dimensions					Interior Dimensions						
Length		Width		Height		Length		Width		Height	
<i>(in.)</i>	<i>(mm)</i>	<i>(in.)</i>	<i>(mm)</i>	<i>(in.)</i>	<i>(mm)</i>	<i>(in.)</i>	<i>(mm)</i>	<i>(in.)</i>	<i>(mm)</i>	<i>(in.)</i>	<i>(mm)</i>
31	785	21.5	545	51	1295	21.5	545	17.5	445	36.5	925
Weight <i>(lbs.)</i> <i>(kg)</i>		Mobile heights listed above are with standard 6" casters.						Volume <i>(ft³)</i> <i>(m³)</i>			
107	48.5							8	.23		

LOBBY MOBILE



DESCRIPTION

The Lobby Mobile is attractive and functional. Its furniture grade appearance allows unobtrusive movement and positioning in public space. Flexible internal configurations meet the varied needs of light or medium public area cleaning.

PRODUCT NUMBER

CL-J6B1V2NH (shown left)
CL-J6B1VRNH-T1 (with external bin)

Exterior Dimensions					Interior Dimensions						
Length		Width		Height		Length		Width		Height	
<i>(in.)</i>	<i>(mm)</i>	<i>(in.)</i>	<i>(mm)</i>	<i>(in.)</i>	<i>(mm)</i>	<i>(in.)</i>	<i>(mm)</i>	<i>(in.)</i>	<i>(mm)</i>	<i>(in.)</i>	<i>(mm)</i>
31	785	21.5	545	51	1295	21.5	545	17.5	455	36.5	925
Weight <i>(lbs.)</i> <i>(kg)</i>		Mobile heights listed above are with standard 6" casters.						Volume <i>(ft³)</i> <i>(m³)</i>			
107	48.5							8	.23		

DESCRIPTION

The versatile Mobile Super Supplier has a 20 cubic foot capacity. Specified with totes, shelves or both, it meets the needs of various customer applications. As a reserve linen unit, the Super Supplier is a "linen closet on wheels." With its furniture grade appearance and security features, the Super Supplier lends itself equally well to back-of-the-house storage or placement in the guest corridors. When teamed up with the power assist option it works as the primary tool for room attendant guest room cleaning.

PRODUCT NUMBER

SSV-STND-J6-08 (shown right)
SSV-PWRV-J8-08 (with power assist)

MOBILE SUPER SUPPLIER



POWER ASSIST UNIT*

ProHost® Power Assist is revolutionizing delivery abilities within the Heart of the House. The virtually silent battery-powered motor propels the Power Assist Mobile at a comfortable walking speed with the simple touch of a button. Power Assist is available on most Housekeeping applications for Mobile Suppliers, Super Suppliers and Junior Suppliers.



* Can only be sold for installation on ProHost® Equipment.

Exterior Dimensions						Interior Dimensions							
Length		Width		Height		Length		Width		Height			
(in.)	(mm)	(in.)	(mm)	(in.)	(mm)	(in.)	(mm)	(in.)	(mm)	(in.)	(mm)		
49	1245	23	585	61	1550	42	1065	17.5	455	46.5	1180		
Weight (lbs.) (kg)						Mobile heights listed above are with standard 6" casters. Mobile widths and lengths include Revolving Bumpers.						Volume (ft ³) (m ³)	
173	78.5							20	.57				

MOBILE TOTE CARRIER



DESCRIPTION

The ProHost® Mobile Tote Carrier, with its economical open frame design, is used to distribute program loaded totes of linen, terry, amenities, glasses and mugs to the guest floor. The Tote Carrier has the largest internal capacity of the ProHost® Mobiles. In housekeeping applications, it is parked in secure guest floor linen rooms or service areas and eliminates the need for static shelving. Tote Carriers can be specified with a variety of tote sizes, caster options and a vinyl cover.

PRODUCT NUMBER
T60LN-J6

"Because linen is loaded into the totes in fixed amounts, the inventory becomes subject to swift and reliable control... inventory of linen can be kept in a "live" condition with very little inventory parked in closets, storerooms and unauthorized places. Inventory tracking can be a straightforward matter with a minimum manual effort."

*The New Back-of-the-House,
Running the Smart Hotel
Robert Propst*

Exterior Dimensions					
Length		Width		Height	
(in.)	(mm)	(in.)	(mm)	(in.)	(mm)
48.5	1230	22	585	67.5	1715
Weight		Mobile heights listed above are with standard 6" casters. Mobile widths and lengths include Revolving Bumpers.			
(lbs.)	(kg)				
115	52				

MOBILE SUPER COLLECTOR



DESCRIPTION

The ProHost® Mobile Super Collector, developed for housekeeping and banquet operations, is designed for the unobtrusive retrieval and transport of soiled linen and trash areas. The upper and lower doors on the Super Collector provide full enclosure, keeping unsightly items out of guest's view. The removable lower door provides fast and easy unloading. Power assist is an optional feature. Optional hanging trash bin shown. (See Accessories for product details).

PRODUCT NUMBER

SCV-STND-J8H00-0A-U0T1 (shown left)
 SCV-PWRV-J8H00-0A-U0T1 (with power assist)

Exterior Dimensions			Interior Dimensions		
Length	Width	Height	Length	Width	Height
<i>(in.) (mm)</i>	<i>(in.) (mm)</i>	<i>(in.) (mm)</i>	<i>(in.) (mm)</i>	<i>(in.) (mm)</i>	<i>(in.) (mm)</i>
49 1245	23 585	61 1550	42 1065	17.5 455	46.5 1180
Weight <i>(lbs.) (kg)</i>	Mobile heights listed above are with standard 6" casters. Mobile widths and lengths include Revolving Bumpers.				Volume <i>(ft³) (m³)</i>
160 72.5					20.5 .58